

TDD antenna

Model: HX-T201A



ELECTRICAL SPECIFICATIONS

General Parameters	Frequency Range (MHz)		Y(2490-2690)
			2490-2690
	Polarization		$\pm 45^\circ$
	Electrical Downtilt ($^\circ$)		2-12
		Electrical Downtilt accuracy ($^\circ$)	± 1
Calibration and Electrical Parameters	Coupling factor between calibration port and each antenna port(dB)		-26 ± 2
	Max.amplitude tolerance from calibration port to input ports(dB)		≤ 1.0
	Max.phase tolerance from calibration port to input ports($^\circ$)		≤ 8
	Ports VSWR		≤ 1.5
	Impedance (Ω)		50
	Max Input Power (W)		300
	Co-polarization isolation between ports(dB)		≥ 25
	Cross-polarization isolation between ports(dB)		≥ 25
Radiation Parameters	Single Column Beam	Horizontal 3dB beam width($^\circ$)	65 ± 5
		Gain (dBi)	16 ± 1
		Vertical 3dB beam width($^\circ$)	5 ± 2
		Cross polar ratio(0°)(dB)	≥ 15
		Cross polar ratio($\pm 60^\circ$)(dB)	≥ 8
		Front to back ratio(dB)	≥ 26
		Upper side lobe suppression (dB)	≤ -15
	Broadcast beam	Gain (dBi)	16 ± 1
		SPR($\pm 32.5^\circ$)(%)	70 ± 15
		SPR($\pm 60^\circ$)(%)	≥ 85
		Vertical 3dB beam width($^\circ$)	5 ± 2
		Front to back ratio(dB)	≥ 26
		Upper side lobe suppression (dB)	≤ -15
	Service beam	0° direct beam gain(dBi)	21 ± 1
		0° direct beam horizontal 3dB beam width($^\circ$)	≤ 30
		0° direct beam sidelobe suppression(dB)	≤ -15
		0° direct beam cross polar ratio(axial)(dB)	≥ 17
		0° direct beam front to back ratio(dB)	≥ 26
		$\pm 30^\circ$ direct beam gain(dBi)	19 ± 1



危险 Dangerous:

高空作业时，操作人员一定要系好安全带，戴好安全帽。
When working high above the ground, the operator must wear safety belts and helmet.

请勿靠近和触摸设备的端子。请穿有长袖衬衫和橡胶手套的防护服。
Wear shoes with rubber soles and heels. Wear protective clothing including a long-sleeved shirt and rubber gloves.

请勿在雷雨、大风天气或者所在区域有闪电或者雷声时作业。请勿靠近金属梯子。
Do not install on a wet or windy day or when lightning or thunder is in the area. Do not use metal ladder.

请勿安装在电源线附近。电源线、电话线和拉线外露情况，任何导线都可能会引入静电干扰。
Do not install near power lines. Power lines, telephone lines, and guy wires look the same. Assume any wire or line can electrocute you.

Guangdong HOSENC Communication Technology Co., Ltd®

Address: No. 100, South Sanshui Avenue, Baini Town, Sanshui District, Foshan City, Guangdong Province

TDD antenna

Model: HX-T201A



MECHANICAL SPECIFICATIONS

Connector(s)	2×(MQ4+MQ5)Connector-Male
Connector position	Bottom
Antenna Dimensions (mm)	1400×320×140
Packing Dimensions (mm)	1645×415×240
Mechanical Downtilt kits (°)	0-12
Radome Color	light gray
Radome Material	Fiberglass
Antenna weight (kg)	≤19
Packing weight (kg)	≤29
Wind Loading @ Velocity,frontal	796N@150 km/h
Wind Loading @ Velocity,lateral	163N@150 km/h
Wind Loading @ Velocity, rear	921N@150 km/h
Wind Speed,maximum	200 km/h
Operating temperature (°C)	-40~+60
Mounting Pipe Diameter (mm)	Φ50~Φ115



Integrated RET Properties

RET type	Replaceable Integrated RET
RET protocol	AISG 2.0/3GPP
Power supply(V)	10-30 DC
Power consumption(W)	≤0.6(Idle, 12V),≤6(in Motion, 12V)
Adjustment time (Full Range)	≤4Mins
Adjustment cycles	> 50,000
Temperature range(°C)	-40~65
Lightning protection	3KA(8/20μs) @ Pin5& Pin3; 5KA(8/20μs) @ Pin1/ Pin6& Pin7
Connectors	2 x 8 Pin circle connector according To IEC 60130-9 And AISG.Daisy chain in:Male,Daisychain out :Female Pin1:12V;Pin3:RS485B;Pin5:RS485A;Pin6:10-30V;Pin7:GND; Pin2 &Pin4 & Pin8:N/C

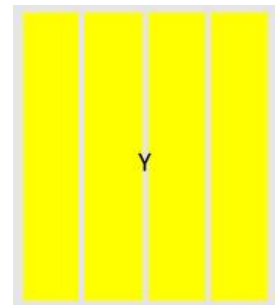
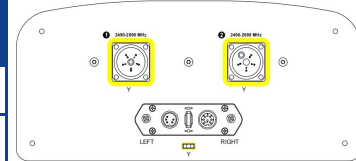

Ant Array	RET Unique ID
Y	HXT201A0NYY XXXXXXY



Guangdong HOSENC Communication Technology Co., Ltd®

Address: No. 100, South Sanshui Avenue, Baini Town, Sanshui District, Foshan City, Guangdong Province

危险 Dangerous:

高空作业时，操作人员一定要系好安全带，戴好安全帽。
When working high above the ground, the operator must wear safety belts and helmet.

请穿橡胶底和橡胶底的鞋子。请穿有长袖袖口和袖口不变的防护服。
Wear shoes with rubber soles and heels. Wear protective clothing including a long-sleeved shirt and rubber gloves.

请勿在雨、雪、大风天气或者所在区域有闪电或者雷声时作业。请勿使用金属梯子。
Do not install on a wet or windy day or when lightning or thunder is in the area. Do not use metal ladder.

请勿安装在电源线附近。电源线、电话线和拉线外露时，任何导线都不能接入设备中。
Do not install near power lines. Power lines, telephone lines, and guy wires look the same. Assume any wire or line can electrocute you.

TDD antenna

Model: HX-T201A

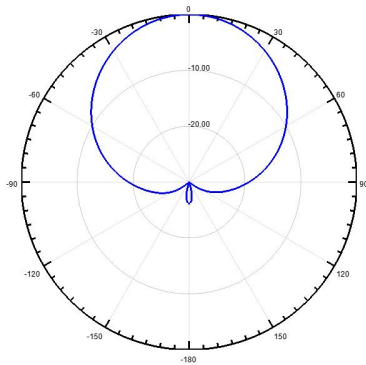

H Pattern

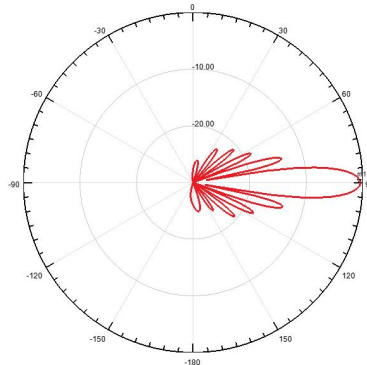

E Pattern

http://www.hosenc.com/page109?product_id=70



Guangdong HOSENC Communication Technology Co., Ltd®

Address: No. 100, South Sanshui Avenue, Baini Town, Sanshui District, Foshan City, Guangdong Province



危險 Dangerous:



高空作业时，操作人员一定要系好安全带，戴好安全帽。
When working high above the ground, the operator must wear safety belts and helmet.



请穿橡胶底和橡胶跟的鞋子，请穿长袖衬衫和橡胶手套的防护服。
Wear shoes with rubber soles and heels. Wear protective clothing including a long-sleeved shirt and rubber gloves.



请勿在雷雨、大风天气或者所在区域有闪电或者雷声时安装，请勿使用金属梯子。
Do not install on a wet or windy day or when lightning or thunder is in the area. Do not use metal ladder.



请勿安装在电源附近，电源线、电话线和拉线外露相同，任何导线都不能接入电源中心。
Do not install near power lines. Power lines, telephone lines, and guy wires look the same. Assume any wire or line can electrocute you.